

PERRY TRYP
0-69-B

CRANSTON COMMONS CONDOMINIUM PHASE 2

RECORDED
1750A07

I hereby certify that this drawing accurately shows the designation, layout and dimensions of CRANSTON COMMONS CONDOMINIUM PHASE 2, as described.

By: [Signature]
Registered Architect No. 6693

0-69-B

[Hatched Box] = Limited Common Area
(644A) = Street Address

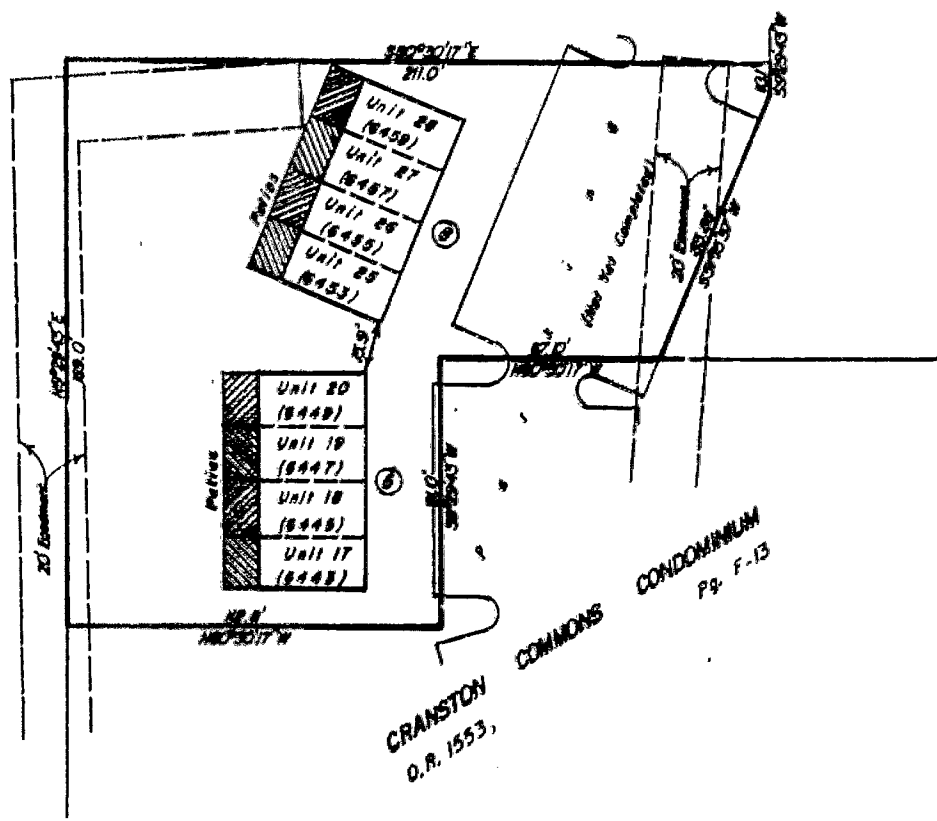

SURVEYED & PLATTED
BY
EVANS, MECHWART, HAMBLETON & TILTON, INC.
CONSULTING ENGINEERS AND SURVEYORS
BAYBERRY, OHIO

I hereby certify that this drawing accurately shows the location of the common areas, facilities and buildings as constructed at CRANSTON COMMONS CONDOMINIUM PHASE 2.

By: Thomas D. Sillbille
Registered Surveyor No. 8668

SCALE: 1" = 40'

MAY 14, 1988

Exhibit 11
Page 1 of 7

79607600