

KRM & INC.  
 CONSULTING ENGINEERS & SURVEYORS  
 EVANS, MECHWART, HAMBLETON & TILTON, INC.

180106850

**PLAT OF 0.008 ACRE PARCEL**  
 Located in Virginia Military Survey No. 1383  
 Being Part of Lot No. 6, Cruzen's Addition  
 City Of Grove City, Franklin County, Ohio



Graphic Scale  
 SCALE: 1"=20'

January, 1994

Record Reference \_\_\_\_\_

The Bearings are based on a Meridian in a bearing system in which the Centerline of Columbus Street, West of Haughn Road has a bearing of North 83°46'00" West and should be used for the determination of horizontal angles only.

**C COLUMBUS STREET**

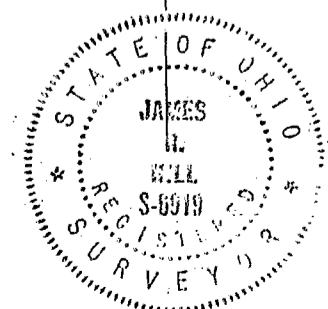
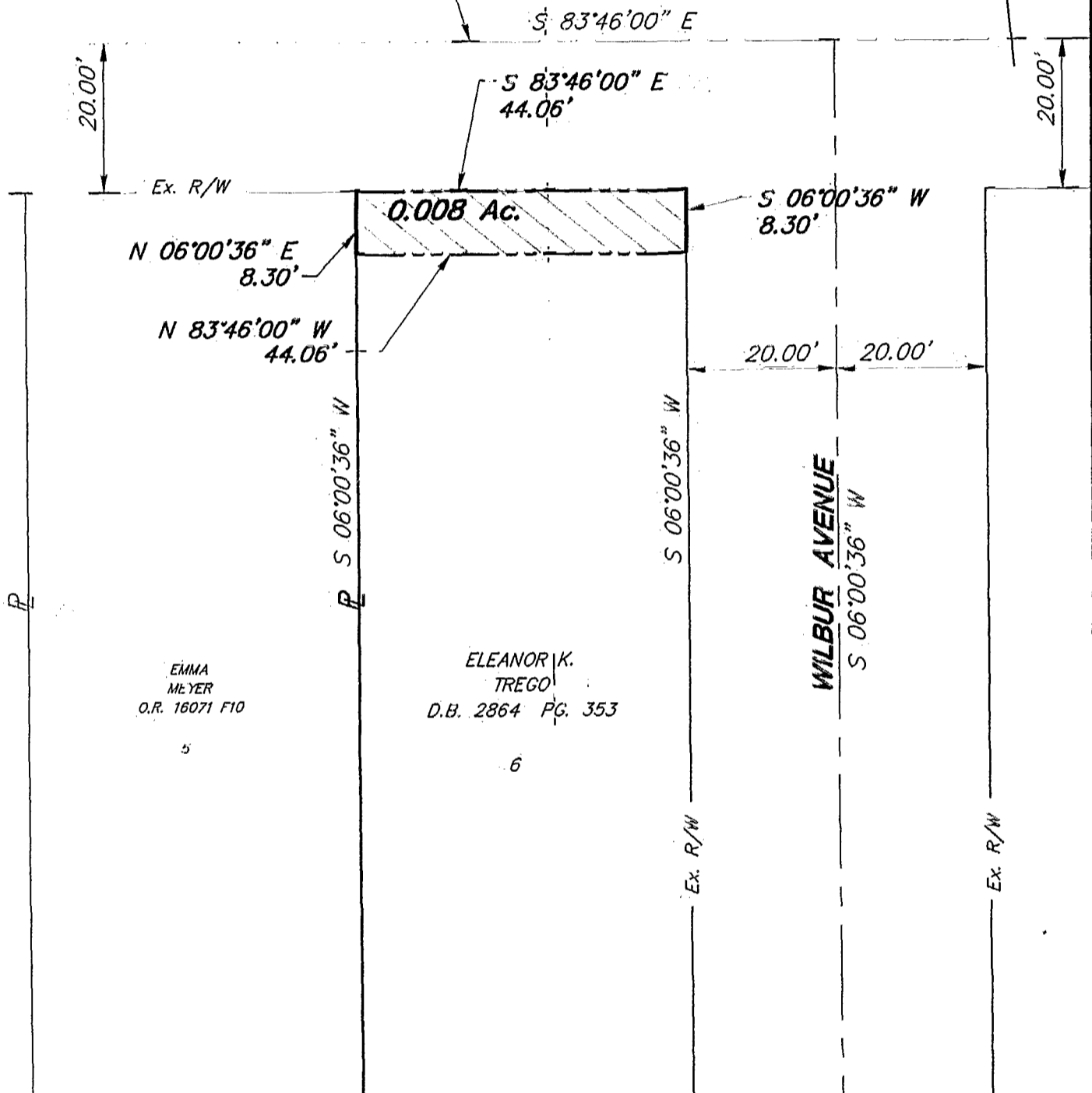

*James R. Hill*  
 Professional Surveyor PS #6919

M-89