

SURVEY PLAN #1

PARK

ST.

50'

S 78° 33' 30" E.

JACKSON TWP
HIGH & ELEMENTARY
SCHOOLS

ADDITION.

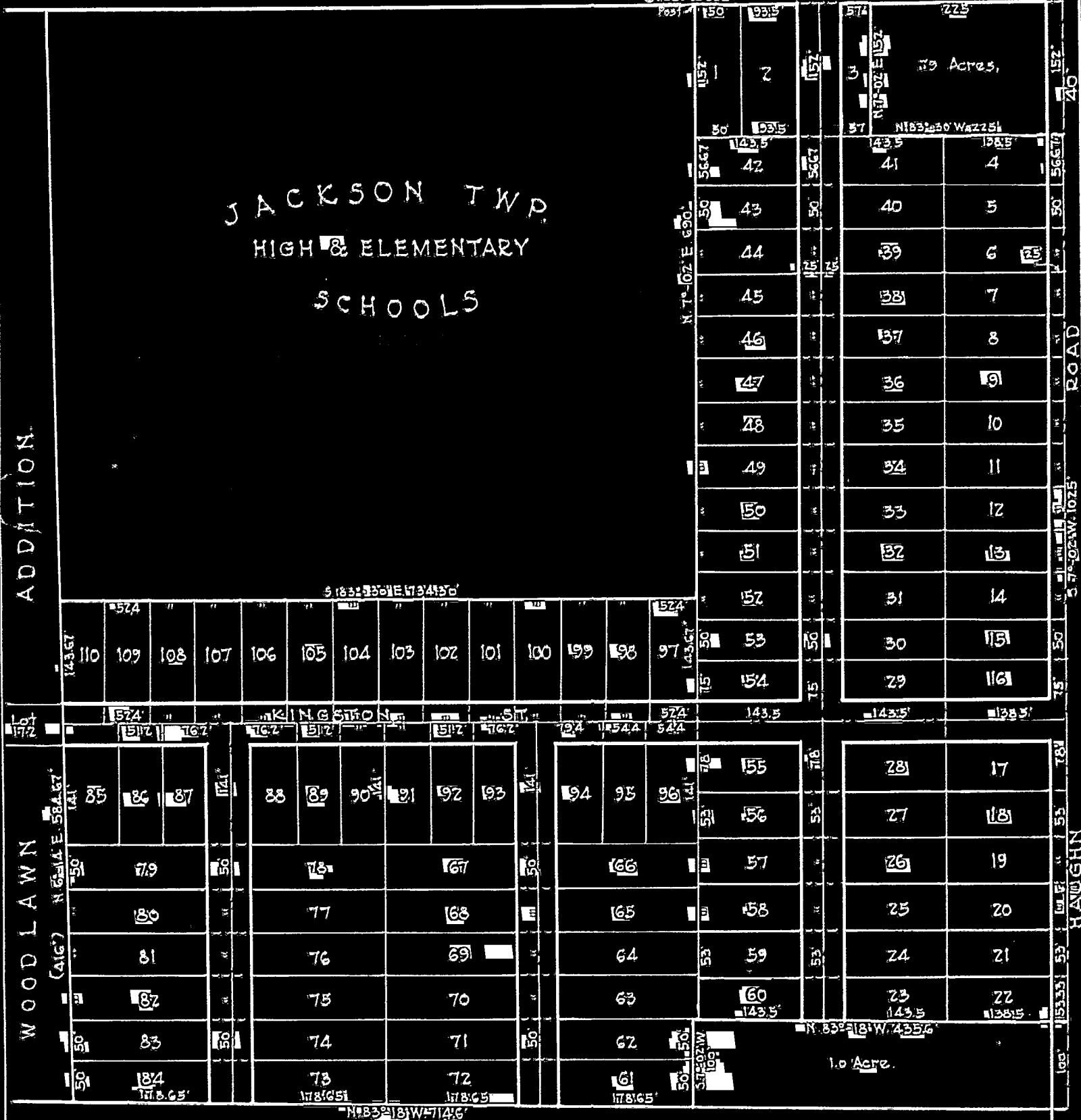

Note-Iron Pipe set at rear corners and 25' back from center line of Roads and Streets.
 All Houses to be set back 150' from E. of Streets, and houses on Park St. to be on line with wood shingle house located on 119 acre tract.
 5' Utility Easement reserved off of rear of interior Parcels 20' off Parcels abutting School property.

PARCEL PLAT OF 20.5 ACRES
LOCATED IN VILLAGE OF GROVE
CITY, FRANKLIN COUNTY, OHIO
FOR A. C. PATZER.
 As surveyed by
R. E. HECKER,
 Registered Surveyor
 Columbus, Ohio

Scale 1"=150' April 30, 1936