

BAUER, DAVIDSON & MERCHANT, INC.

CONSULTING ENGINEERS

255 GREEN MEADOWS DRIVE SOUTH P.O. BOX 370 POWELL, OHIO 43065
 PHONE: 614-846-3393 FAX: 614-846-4575

BOUNDARY SURVEY OF A 0.080 ACRE TRACT OF LAND LOCATED
 NORTH OF I-270 AND WEST OF GANTZ ROAD IN THE CITY
 OF COLUMBUS, COUNTY OF FRANKLIN, STATE OF OHIO
 FRANKLIN, STATE OF OHIO

0-32-A
JACKSON TWP.

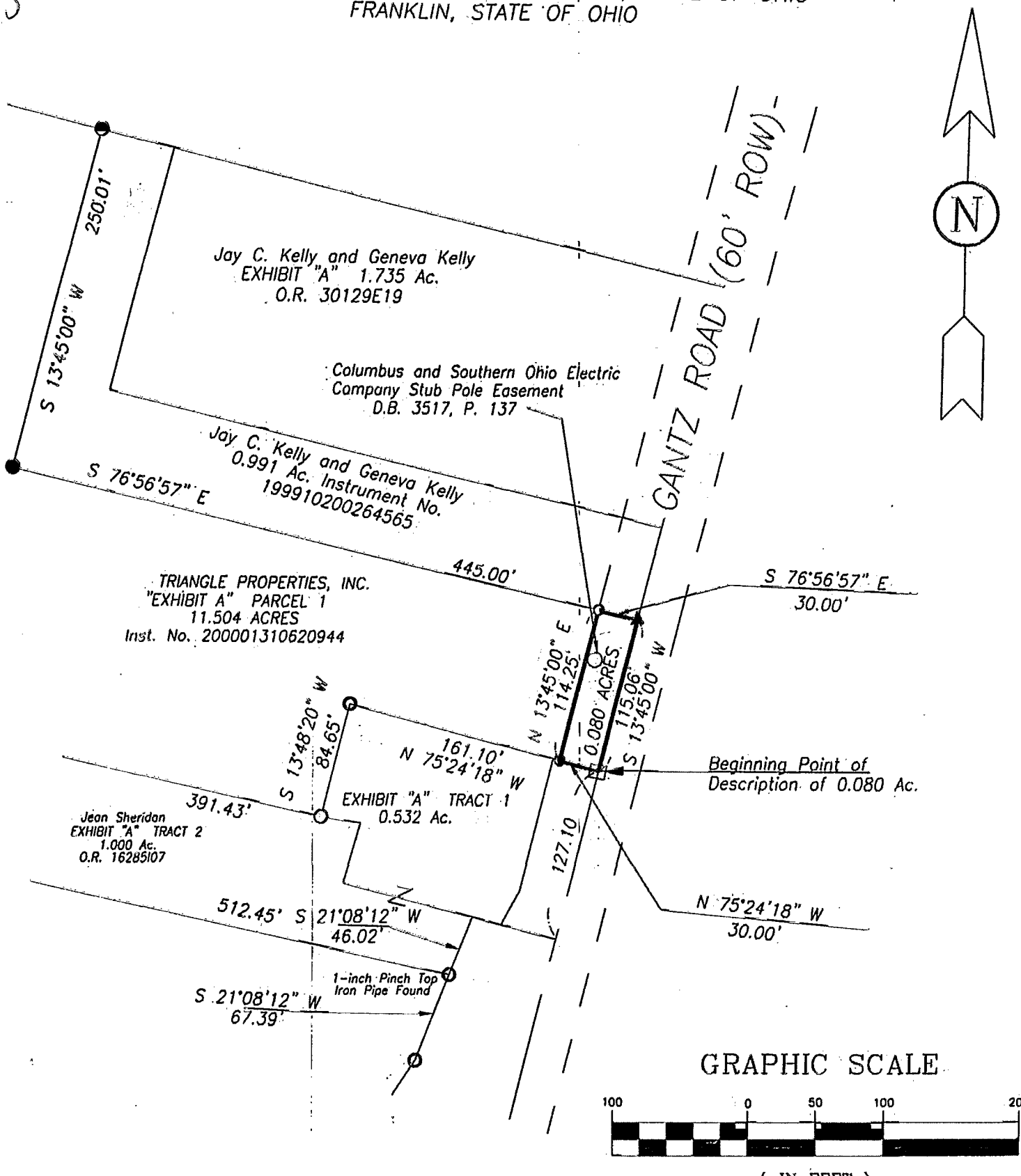

GRAPHIC SCALE

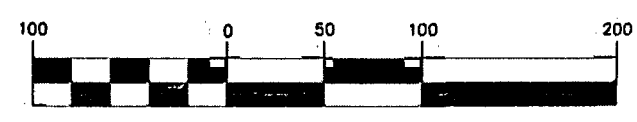

(IN FEET)
1 inch = 100 ft.

Situated in the State of Ohio, County of Franklin, City of Columbus, being in Virginia Military Survey No. 6839 and containing 0.080 acres of land, more or less, said 0.080 acres being part of that 11.504 acre tract of land (residue of original 15 acres of land) designated as PARCEL 1 and described in "EXHIBIT A" in the deed to Triangle Properties, Inc., of record in Instrument No. 200001310620944, Recorder's Office, Franklin County, Ohio.

We hereby state that the above map was prepared from information obtained from actual field surveys conducted by Bauer, Davidson & Merchant, Inc. in March of 1999 and in August of 2000.

The bearings shown on this map are based on the bearings correspond to the bearing of S 13°45'00" W for the centerline of Gantz Road as referred to in the deed to Jay C. Kelley and Geneva Kelly, of record in Instrument No. 30200J19, Recorder's Office, Franklin County, Ohio.

LEGEND

- 3/4-inch (ID) Iron Pipe Found
- 3/4-inch (ID) Iron Pipe Set
- Monument Found
- Railroad Spike Set

SCALE: 1"=100'
ORDER NO. 1657-00
AUGUST 8, 2000

STATE OF OHIO
 WILLIAM DOUGLAS BEER
 S-7980
 PROFESSIONAL SURVEYOR
 BAUER, DAVIDSON & MERCHANT, INC.
 CONSULTING ENGINEERS
 BY *William D. Beer*
 William D. Beer
 Professional Surveyor No. 7980

5269018