

THE THOMAS ENGINEERING & SURVEYING COMPANY

3203 WEST BROAD STREET

COLUMBUS 4, OHIO

18235 732.5

ORDER NO. 1022-51

PLAT OF
DIVISION OF A TEN FAMILY RICK APARTMENT
ON EAST BLAKE AVENUE & NORTH HIGH
STREET
for
MICHAEL B. KARR

B.P.

SCALE 1" = 20'
SEPT 11, 1951

CROSS ON TOP OF CAP ON CHAIN LINK FENCE POST
INCLUDING 0.50' SURPLUS
50.70'

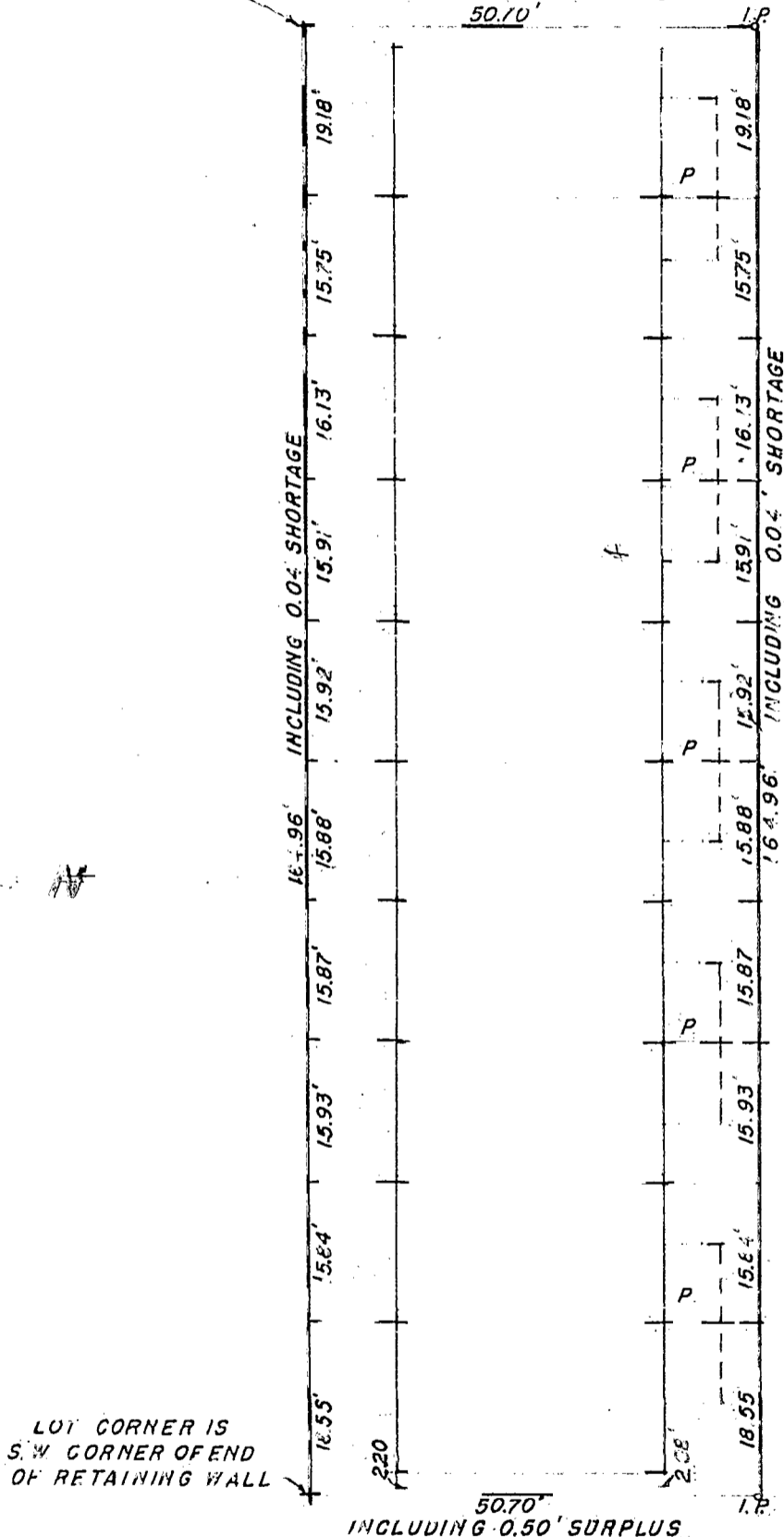

CURB CUT ON CURB +

NORTH HIGH ST. 66'

We hereby certify that the foregoing drawing was prepared from an actual survey of the premises and correctly shows the location of the boundaries.

THE THOMAS ENGINEERING & SURVEYING CO.

Registered Engineer & Surveyor

Checked by

Drawn by J.P.A.

Harley P. Smith