

79107700

0-107-E
WASHINGTON Twp

PAGE 02

RAAB SURVEYING

614-445-7103

05/21/2002 14:53

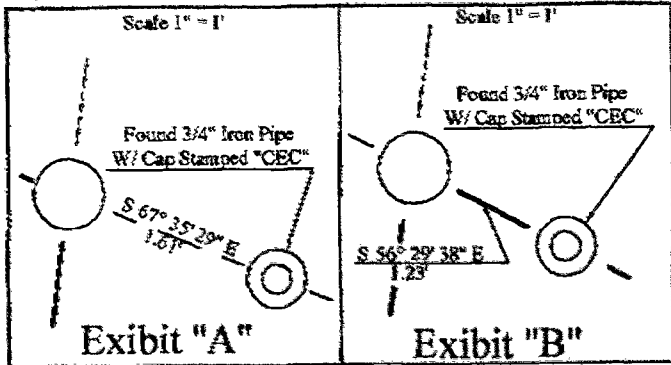

SURVEY PLAT

Situated in the State of Ohio, County of Franklin, Township of Washington, part of Survey No. 2543, Virginia Military Lands, and being a part of a 14.118 acre tract conveyed to Wallace, Bradley and Wallace, an Ohio general partnership, by instrument number 17377103

12.580 Acre Tract
Gretchen A. Distelhorst
Official Record 26330
Page C08

Found 3/4" Iron Pipe
W/ Cap Stamped "CEC"
Bearing N 66° 39' 06" W
7.00' from property corner

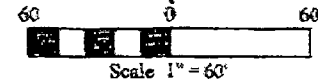

BASIS OF BEARINGS

THE BASIS OF BEARINGS FOR THIS SURVEY ARE BASED ON THE CENTERLINE OF BRAND ROAD BEING N 67° 48' 07" W, AS SHOWN ON PAGE NUMBER 172 OF 183, CENTERLINE SURVEY PLAT FOR COFFMAN ROAD IMPROVEMENTS.

14.118 Acre Tract
Wallace Bradley and Wallace Partnership
Official Record 17377
Page 103

8,000 Acre Tract
Jerry G. Hill, and Marsha M Spears
Official Record 5537
Page 104

0.701 Acre Tract
William and Etta Morris
Deed Book 3597
Page 226

0.998 Acre Tract
Robert G. Mustard
Official Record 23948
Page A06

0.363 Acres
out of a 14.118 Acre Tract



CERTIFICATION

I HEREBY CERTIFY THIS PLAT WAS MADE BY USING FIELD MEASUREMENTS OBTAINED BY AN ACTUAL FIELD SURVEY CONDUCTED IN MAY, 2002 AND IS IN CONFORMANCE WITH THE MINIMUM STANDARDS FOR BOUNDARY SURVEYS IN THE STATE OF OHIO.

1.446 Acre Tract
Kristan A. Swingle
Official Record 15214
Page G01

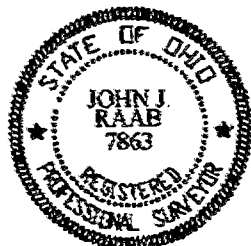

LEGEND

Symbol	Description
○	Iron Pin Set
⊗	RR Spk Fad
⊙	Iron Pipe Found
⊕	Railroad Spike Set

John J. Raab 5/21/02
John J. Raab P.S.

DRAWN BY: Ryan Beatty	APPROVED BY: John J. Raab P.S.	REVISORS:	Project:
DATE: May 13, 2002	PROJ. NO.:		Wallace Split for The City of Dublin
DWG. NO.: Wallace.DWG	DWG: Wallace.DWG		

RAAB Surveying, LLC
"FOCUS ON QUALITY"
WWW.RAABSURVEYING.COM

637 Marsh Rd.
Columbus, Ohio 43207
John J. Raab, P.E., President
Phone: 614-445-6608
Fax: 614-445-7108