

BAUER, DAVIDSON & MERCHANT, INC.

CONSULTING ENGINEERS

255 GREEN MEADOWS DRIVE SOUTH

P.O. BOX 370

POWELL OHIO 43065

BOUNDARY SURVEY MAP OF ACREAGE PARCELS OF LAND LOCATED ON THE NORTH SIDE OF PARK ROAD AND WEST OF STORROW DRIVE, IN THE CITY OF COLUMBUS, COUNTY OF FRANKLIN, STATE OF OHIO

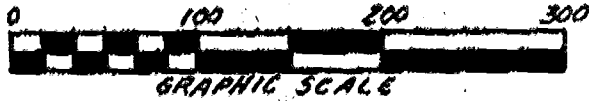

DAVIDSON-PHILLIP, INC.
67,737 AC.
O.R. 08512714

DONALD R. KENNEY, TRUSTEE
19,170 AC.
O.R. 08159E20

DONALD R. KENNEY, TRUSTEE
21,485 AC.
O.R. 08159E17

38.837 AC.

—○— Indicates 4* inch (I.O.) iron pipe unless otherwise noted.

①	N-3°08'32"W	30.17
②	N-3°08'32"W	514.80
③	N-87°01'22"W	50.29
④	N-86°53'28"E	103.36
⑤	S-3°08'32"E	195.24
⑥	S-87°01'22"E	48.07
⑦	S-2°56'38"W	56.00
⑧	N-87°01'22"W	27.01
⑨	S-3°08'32"E	181.84
⑩	S-86°53'28"W	54.94
⑪	S-3°08'32"W	308.70
⑫	N-86°53'28"E	96.58
⑬	S-3°08'32"E	228.16
⑭	N-87°01'22"W	110.82
⑮	S-23°30'00"E	181.63
⑯	S-14°42'24"E	100.90
⑰	S-7°15'32"W	150.82
⑱	S-21°30'00"W	187.28
⑲	S-72°20'42"E	122.02

N 86°47'54"W
91.52'

N 87°01'22"W 913.60'

Reference point of beginning for description of 1.818 Acres and point of beginning for description of 38.837 Acre tracts

⑮ Δ -4°21'47", R-775.00
Ch-S-15°28'25"W, 59.00

⑲ N-76°42'28"W 134.05

The 38.837 acre tract and the 1.818 acre tract are situated in the State of Ohio, County of Franklin, City of Columbus, being in Section 2, Township 2, Range 18, United States Military Lands, 17,352 acres of said 38.837 acres being part of that 19,170 acre tract of land described in the deed to Donald R. Kenney, Trustee, of record in Official Record 08159E20 and 21,485 acres of said 38.837 acres being all of that 21,485 acres described in the deed to Donald R. Kenney, Trustee, of record in Official Record 08159E17, said 1.818 acre tract being part of that 19,170 acres described in the Deed to Donald R. Kenney, Trustee, of record in Official Record 08159E20, all being of record in the Recorder's Office, Franklin County, Ohio.

The bearings shown on the foregoing map are based on the bearing of N-3°08'32"W, for the westerly line of said 19,170 acre tract of land in Official Record 08159E20, Recorder's Office, Franklin County, Ohio.

We hereby certify that the foregoing map was prepared from information obtained from an actual field survey conducted by Bauer, Davidson & Merchant, Inc. in July of 1988 and in October of 1992.

BAUER, DAVIDSON & MERCHANT, INC.
Consulting Engineers

John W. McCombs
John W. McCombs
Professional Surveyor No. 6661

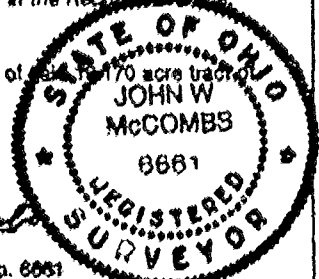

097-B