

21-0

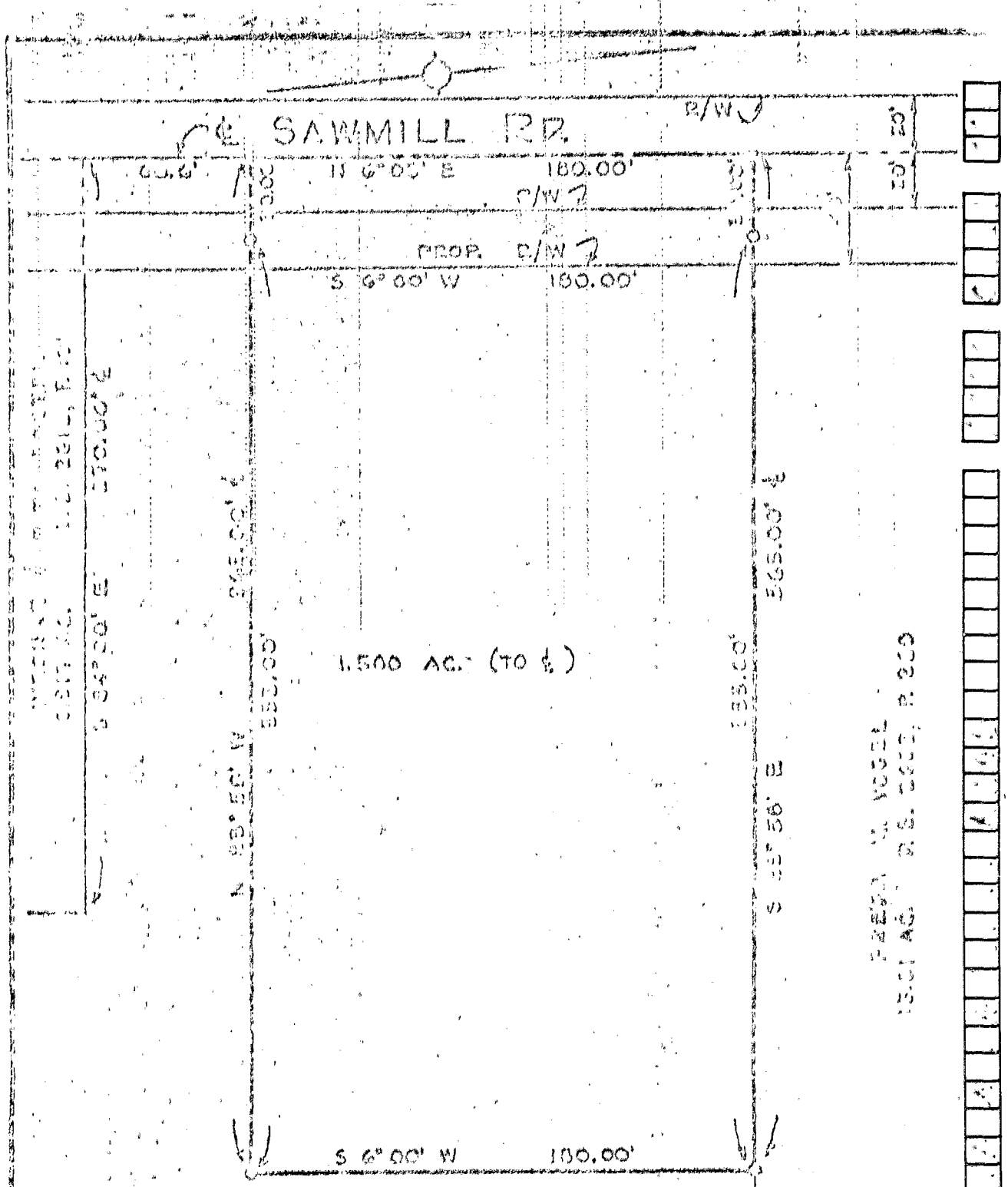

SAWMILL RD. 180.00' ±

1.500 AC. (TO ±)

PERRY TWP. VOGEL
1501 AC. D.S. 2602, P. 209

HIRAM B. & MARY G. PORTER
P.B. 1888, P. 141 & D.B. 2046, P. 446

SURVEY OF 1.500 AC. IN FARM LOT 32 IN 1ST
T. 2 N., R. 19 W., U.S.M.L., PERRY TWP, FRANKLIN
COUNTY, OHIO, AT 7860 SAWMILL RD FOR H. B. FRY

SCALE: 1" = 50'

NOV. 2, 1970

C.F. BIRD & R.J. FULL, LTR
619 LINWORTH RD.
WORTHINGTON, OHIO

Richard J. Duce

• RAILROAD
○ IRON PIN