

SCALE 1" = 200'
E-HIGHWAY EASEMENT
TAXING DISTRICT CODE
MADISON TWP 18C

FRANKLIN COUNTY SURVEY MONUMENTS

- ① DROP FRANKLIN COUNTY OHIO 3-8-94 0.050 Ac.
- ② 4984 DED. OF PORT ROAD, ALUM CREEK DRIVE B WRIGHT BROTHERS AVENUE 5-17-95 (A)=0.172 Ac. (B)=0.945 Ac. (C)=0.557 Ac. (D)=0.545 Ac. (E)=0.913 Ac. (F)=0.289 Ac. (G)=0.358 Ac.
- ③ DEDICATION OF JOHN GLENN AVENUE

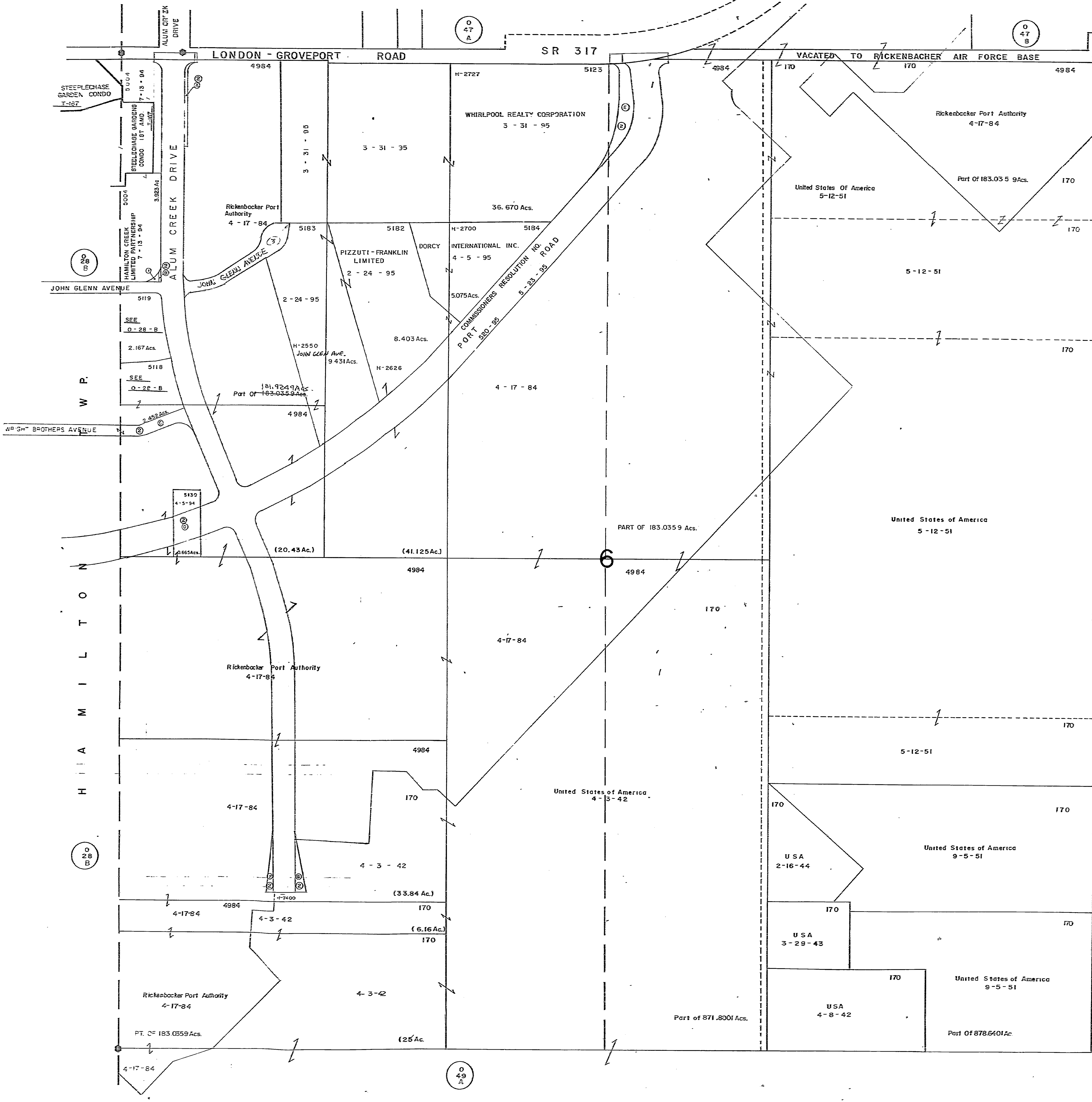

HAMILTON CREEK LIMITED PARTNERSHIP
7-18-94
3.923 Ac.

STEEPLECHASE GARDEN CONDO
T-57

WRIGHT BROTHERS AVENUE

5139
4-5-94

2.665 Ac.

Rickenbacker Port Authority
4-17-84

4-17-84

4-17-84

4-17-84

Rickenbacker Port Authority
4-17-84

PT. OF 183.0359 Ac.

4-17-84

4984

3-31-95

5183

5119

5118

2.452 Ac.

181,924.9 Ac.
Part Of 183.0359 Ac.

4984

4-17-84

4984

4-17-84

4-17-84

4-17-84

Rickenbacker Port Authority
4-17-84

4-17-84

5123

3-31-95

5182

5119

5118

2.452 Ac.

181,924.9 Ac.
Part Of 183.0359 Ac.

4984

4-17-84

4984

4-17-84

4-17-84

4-17-84

Rickenbacker Port Authority
4-17-84

4-17-84

H-2727

3-31-95

5182

5119

5118

2.452 Ac.

181,924.9 Ac.
Part Of 183.0359 Ac.

4984

4-17-84

4984

4-17-84

4-17-84

4-17-84

Rickenbacker Port Authority
4-17-84

4-17-84

5123

3-31-95

5182

5119

5118

2.452 Ac.

181,924.9 Ac.
Part Of 183.0359 Ac.

4984

4-17-84

4984

4-17-84

4-17-84

4-17-84

Rickenbacker Port Authority
4-17-84

4-17-84

H-2700

3-31-95

5182

5119

5118

2.452 Ac.

181,924.9 Ac.
Part Of 183.0359 Ac.

4984

4-17-84

4984

4-17-84

4-17-84

4-17-84

Rickenbacker Port Authority
4-17-84

4-17-84

5123

3-31-95

5182

5119

5118

2.452 Ac.

181,924.9 Ac.
Part Of 183.0359 Ac.

4984

4-17-84

4984

4-17-84

4-17-84

4-17-84

Rickenbacker Port Authority
4-17-84

4-17-84

H-2700

3-31-95

5182

5119

5118

2.452 Ac.

181,924.9 Ac.
Part Of 183.0359 Ac.

4984

4-17-84

4984

4-17-84

4-17-84

4-17-84

Rickenbacker Port Authority
4-17-84

4-17-84

5123

3-31-95

5182

5119

5118

2.452 Ac.

181,924.9 Ac.
Part Of 183.0359 Ac.

4984

4-17-84

4984

4-17-84

4-17-84

4-17-84

Rickenbacker Port Authority
4-17-84

4-17-84

H-2700

3-31-95

5182

5119

5118

2.452 Ac.

181,924.9 Ac.
Part Of 183.0359 Ac.

4984

4-17-84

4984

4-17-84

4-17-84

4-17-84

Rickenbacker Port Authority
4-17-84

4-17-84

5123

3-31-95

5182

5119

5118

2.452 Ac.

181,924.9 Ac.
Part Of 183.0359 Ac.

4984

4-17-84

4984

4-17-84

4-17-84

4-17-84

Rickenbacker Port Authority
4-17-84

4-17-84

H-2700

3-31-95

5182

5119

5118

2.452 Ac.

181,924.9 Ac.
Part Of 183.0359 Ac.

4984

4-17-84

4984

4-17-84

4-17-84

4-17-84

Rickenbacker Port Authority
4-17-84

4-17-84

5123

3-31-95

5182

5119

5118

2.452 Ac.

181,924.9 Ac.
Part Of 183.0359 Ac.

4984

4-17-84

4984

4-17-84

4-17-84

4-17-84

Rickenbacker Port Authority
4-17-84

4-17-84

H-2700

3-31-95

5182

5119

5118

2.452 Ac.

181,924.9 Ac.
Part Of 183.0359 Ac.

4984

4-17-84

4984

4-17-84

4-17-84

4-17-84

Rickenbacker Port Authority
4-17-84

4-17-84

5123

3-31-95

5182

5119

5118

2.452 Ac.

181,924.9 Ac.
Part Of 183.0359 Ac.

4984

4-17-84

4984

4-17-84

4-17-84

4-17-84

Rickenbacker Port Authority
4-17-84

4-17-84

H-2700

3-31-95

5182

5119

5118

2.452 Ac.

181,924.9 Ac.
Part Of 183.0359 Ac.

4984

4-17-84

4984

4-17-84

4-17-84

4-17-84

Rickenbacker Port Authority
4-17-84

4-17-84

5123

3-31-95

5182

5119

5118

2.452 Ac.

181,924.9 Ac.
Part Of 183.0359 Ac.

4984

4-17-84

4984

4-17-84

4-17-84

4-17-84

Rickenbacker Port Authority
4-17-84

4-17-84

H-2700

3-31-95

5182

5119

5118

2.452 Ac.

181,924.9 Ac.
Part Of 183.0359 Ac.

4984

4-17-84

4984

4-17-84

4-17-84

4-17-84

Rickenbacker Port Authority
4-17-84

4-17-84

5123

3-31-95

5182

5119

5118

2.452 Ac.

181,924.9 Ac.
Part Of 183.0359 Ac.

4984

4-17-84

4984

4-17-84

4-17-84

4-17-84

Rickenbacker Port Authority
4-17-84

4-17-84

H-2700

3-31-95

5182

5119

5118

2.452 Ac.

181,924.9 Ac.
Part Of 183.0359 Ac.

4984

4-17-84

4984

4-17-84