

70055

(S 702 S)

O
88
F

O
88
F

Harry Denure
10-3-69

22.95Ac

O
88
F

CON. RAIL CORP
1-29-79

CONRAIL

1-29-79

City National Bank & Trust Co. Tr. Et Al (4)
10-27-61 7-24-67

O
88
D

2535

City National Bcnk & Trust Co. Tr
et al (4)
10-27-61
7-24-67

128336

12955

13244

Total = 23.79Ac

ROAD
PLAT R.S. OFFICE
LISLE PLAT R.S. OFFICE
HANNAH PAGE 349 RECORDER'S OFFICE
HANNAH PAGE 349 RECORDER'S OFFICE
PAGE 17

- ① 2192 Vernon L. & Janet A. Russell 10-15-85
- ② 1913 Charles R. Major 6-75-78
- ③ 1496 CYNTHIA A. KAGLE & MARK D. MAIER 8-15-70 C. 30 87
- ④ 1672 Ronald R. & Glenn F. Smith 5-11-64
- ⑤ 1671 Hazel M. Vollmer 10-16-56
- ⑥ 1670 Clarence F. & Jane Barnard 5-6-85
- ⑦ 1669 George O. Matthews-Tr. 1 To Carr H-4-82 9-24-85 C.G.R. INC 11386
- ⑧ 1936 Helen M. Randall 12-18-67

O
88
D

0-88-E

PRAIRIE TWP.



SCALE 1" = 200'

V.M.S.
E=HIGHWAY EASEMENT
TAXING DISTRICTS DISTRICT CODE
PRAIRIE TWP 240
PRAIRIE TWP HILLIARD SD 241

H--- HOUSE NUMBERS

6716

5237

BROWN

TWP

**578

**582

**582

10-3-69

Harry Denune
10-3-69
1-555

10616

(43994Ac.)

Total = 64.725 Ac.

5227

22.95Ac.

(19962Ac.)

CON. RAIL CORP. 1-29-79

PT. OF 55.946Ac.

R.R.

2534

1325

1325

1325

COM. COURT RECORD BOOK 44 PAGE 62

CLERK'S OFFICE

LOT 6

LOT 5

LOT 4

5210

12-29-42

Elmo D & Geneva L. Spring
12-29-42

12-29-42

Total = 38.76Ac.

(19.38Ac.)

(19.38Ac.)

(19.38Ac.)



H-7100

64



MARJORIE
Marjorie E. Antrim
4-24-73

5002

5106

23.79Ac.

HANNAH LITTLE RECORDER
PLAT BOOK 17 PAGE 349

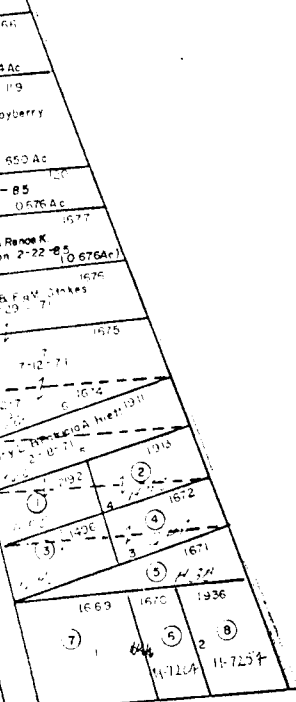

155.76Ac.

W. BROAD ST.

U.S. 40



0-88-E

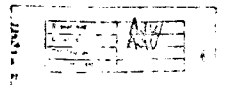

13618

1296