

0
61
B

Survey by Robert & Anita Parrett
2-18-81
Robert W. Anita K. Parrett
3-21-81

DAVIDSON ROAD

3046
3735

3061
4.015 Ac
Louise A. & G.L. Regula
7-19-73

Kathryn B. Vonschoyck
12-17-80

Acme Holding Company
Trustee
Acme Corp.
1-20-88

Part of 55.057 Ac
(25.985 Ac)

(30 Ac.)

3166 3167
0.619 Ac 0.619 Ac
3569 3570
11-13-86 11-13-86
-516 Ac -516 Ac

3054
James L. & Lois G. Koons
6-16-80
Acme Holding Company
6-11-87
3.4145 Ac.

LANDINGS
SECTION

Acme Holding Company
9-16-86 1-20-88

Total = 96.297 Ac.
(33.902 Ac.)

3053
Acme Holdings Co.
Edward J. Herrmann - Bishop
10-26-73
6-4-87
3-21-85

Edward J. Herrmann
10-26-73

RIVER LANDINGS

32.28 Ac

9-16-86 N-47 H

SECTION NO.

BRAIDWOOD DRIVE

RIDGEWOOD

WENWOOD DRIVE

ESTATES

RIDGEWOOD DRIVE

NO. 2

DARBYSHIRE

DRIVE

N-44-G & H

RIDGEWOOD

RIDGEWOOD DRIVE

ESTATES

DARBYSHIRE DRIVE

AMENDED

1406

DARBYSHIRE COURT

0
61
C

0
61
D

N
42
D

0
61
F

O-61-D
NORWICH TWP



SCALE 1" = 200'
E-HIGHWAY EASEMENT
V.M.S.

TAXING DISTRICT _____ DISTRICT CODE
NORWICH TWP 200
CITY OF HILLIARD 050

H... HOUSE NUMBERS

FRANKLIN COUNTY SURVEY MONUMENT

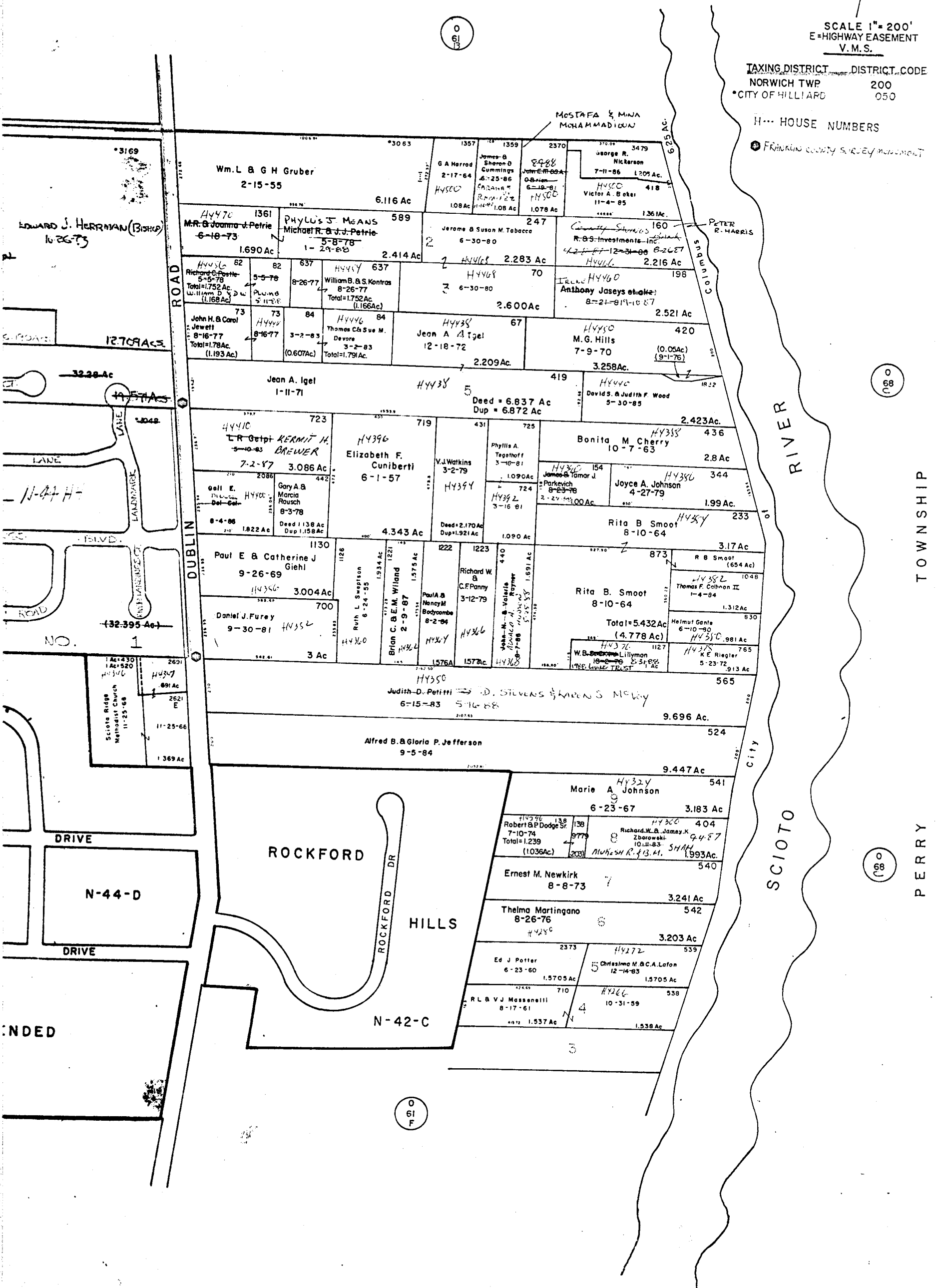

TOWNSHIP

PERRY