

47

4-3-42
PICKENBACHER
PORT
AUTHORITY
4-3-42
4-3-42
(4Ac)

170

170

4-3-42

(39.80Ac.)

T W P

United State Of America
4-3-42

4-3-42

170

28

(37.80Ac.)

(80Ac)

Vac. Co. Comm. R.R. 16 - Pg. 159

3-13-42

HAMILTON

4-3-42

PICKENBACHER
PORT
AUTHORITY
4-17-84

(53.50Ac)

170

170
4985

United State Of America
4-3-42

PICKENBACHER PORT AUTHORITY
4-17-84

PICKENBACHER
United Stat
4-3-
4-17

(53.50Ac)

170
4985

PICKENBACHER PORT AUTHORITY
4-3-42
4-17-84

170

(53.50Ac)

PART OF 876 ACRES

Total = 905.705

PICKAWAY

0-49-A
MADISON TWP
R.21 TWP2

SCALE 1"=200'
E=HIGHWAY EASEMENT
TAXING DISTRICT DISTRICT CODE
MADISON 180
FRANKLIN COUNTY SURVEY AGREEMENT

0
49
B

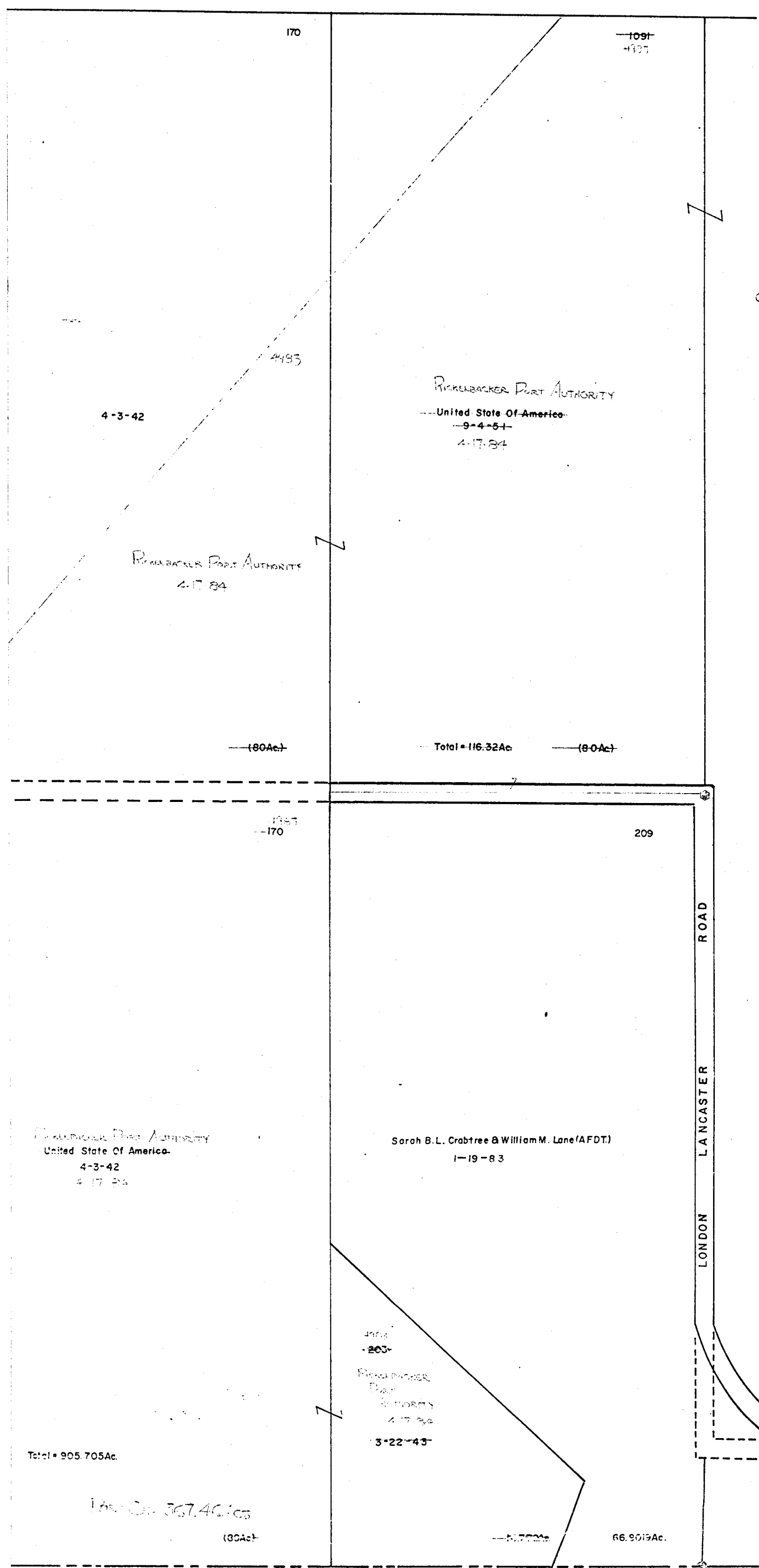

4-3-42

4493

RICKENBACKER PORT AUTHORITY
United State Of America
-9-4-5-
4-17-84

RICKENBACKER PORT AUTHORITY
4-17-84

(80Ac)

Total = 116.32Ac

(80Ac)

1185
-170

209

RICKENBACKER PORT AUTHORITY
United State Of America
4-3-42
4-17-84

Sarah B.L. Crabtree & William M. Lane (AFDT)
1-19-83

400
-203-
RICKENBACKER
PORT
AUTHORITY
4-17-84
3-22-43

Total = 905.705Ac

165.00 367.40 Ac
(80Ac)

(80Ac)

66.9019Ac

0-49-A

C O U N T Y

| | |
|--|--|
| | |
| | |
| | |