

0
23
A

0
23
A

23

0
23
E

O-23-B
HAMILTON TWP
R. 22 TWP 4



SCALE 1"=200'
E=HIGHWAY EASEMENT
TAXING DISTRICT DISTRICT CODE
•• COLUBUS 010
H--HOUSE NUMBERS

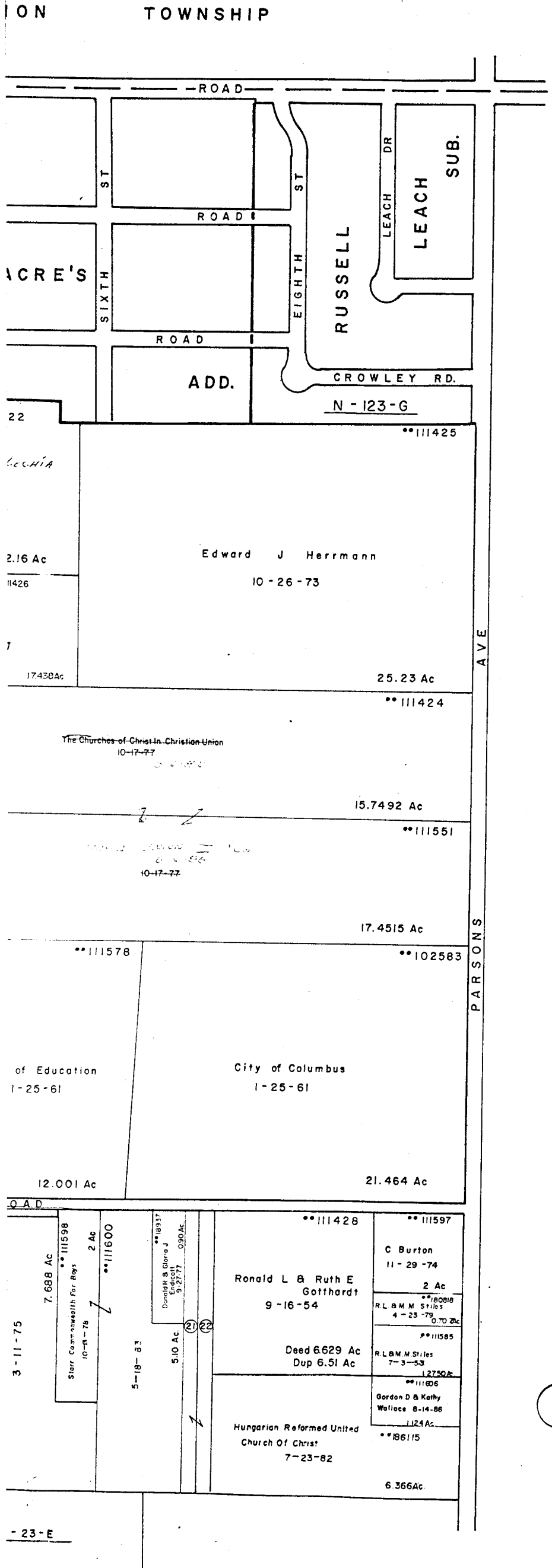

0
23
C

0
23
C

1	**111560	Bob Evans Farms Inc.	9-3-82	1.095 Ac
2	**4575	Bob Evans Farms Inc.	9-3-82	.235
3	**4518	"	"	.301
4	**4570	"	9-13-82	.735
5	**111588	R.T. & B.A. Sams	10-25-72	.5575
6	**111574	Ronald T. & B.A. Sams	7-3-78	1.00
7	**16530	EMRC MARKETING CO	5-21-70	.608
8	**4564	Bob Evans Farms Co.	9-13-82	.058
9	**4500	City of Cols	7-30-77	.596
10	**4487	DROP	"	.076
11	Drop	"	8-26-69	.117
12	**111572	Gloria G Ball	12-13-74	.253
13	**111571	Barbara L. James ETAL 3	11-13-85	.279 Ac.
14	**111586	"	"	.55
15	**18071	Earle G. M. N. Yockey	10-7-86	.517
16	**111583	Anna J. Blair	1-7-87	.75
17	**111569	Paul Whiting	6-11-84	.275
18	**111539	Olivia P. Galford	1-31-79	.662
19	Drop	City of Cols	3-24-75	.0815
20	Drop	"	3-24-75	.312
21	**111601	R & L Endicott	9-11-63	1.
22	**111604	"	9-11-63	1.
23	**111564	Gall M. Kelley	12-8-82	0.529 Ac.
24	**143101	Lawrence L. & Sharon L. Kelley	8-10-76	0.413 Ac.
25	**117081	George R. & Carole F. Goodfleisch	4-9-76	0.496 Ac.
26	**139690	Timothy B. J. Kelley	7-1-84	1.146 Ac.
27	**118168	STEVENS, P. & CARLA KELLEY	7-24-87	0.272 Ac.
28	**103322	Jos. W. & G.M. Watkins	8-27-70	0.344 Ac.
29	**128878	Betty J. Dean	6-17-76	0.344 Ac.
30	**11066	M.C.R. Real-Estate Co.	11-1-83	1.353 Ac.
31	**190303	Color Tile Supermart Inc.	12-22-81	0.636 Ac.
32	Drop	City of Cols (H-Way)	6-22-82	0.437 Ac.
33	**211024	EMRC MARKETING CO	1-12-89	0.1229 Ac.