

LANGDON D & Emily E. Bell 12-6-73
0.50 Equitable Development Corp. 378A

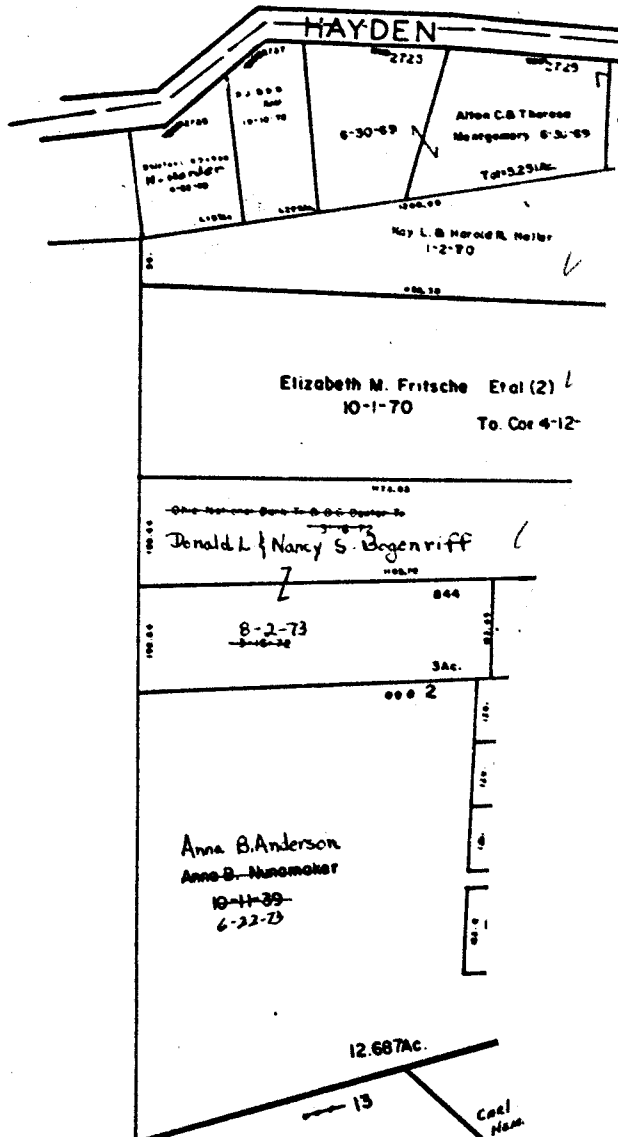

2418

0 91 A

COMPLETE RECORD 53-384
SURVEYOR'S PLAT BOOK 1-167

COMPLETE RECORD 158 42A

0 835 0 1

FORCAL CORPORATION
The Equitable Development Corp.
3-30-71
11-9-73

Pt. Of 259.823 Ac.

Deed = 90Ac.
(88.21Ac)

SURVEYOR'S PLAT BOOK 2-120 & 122
DAVIDSON

0 80 C

3611

1000



SCALE 1" = 200'
V.M.S.
TAXING DISTRICTS
NORWICH
NORWICH WASHINGTON S.D.

T.W.P.

P E R R Y

