

STATE

CITY OF COLUMBUS (ET. CP. 242379)
~~Zenith Holding Co.~~
~~1-10-69~~
5-30-73

CITY OF COLUMBUS (ET. CP. 242379)
~~1-10-69~~
5-30-73

CITY OF COLUMBUS (ET. CP. 242379)
~~1-10-69~~
5-30-73

City of Columbus
3-24-54

104429

96153

City of Columbus
3-27-56

City of Columbus
Ord. 430-48 (5-10-48)
Ord. 880-48 (11-22-48)

4

(Part of 39.63 Ac)

SEVENTEENTH

(25.53 Ac)

96153

City of Columbus

SEVENTEENTH

RELOCATED

AVE. VAC. 11-13-51

RD. REC. 17-R164

VAC. RD. REC. 17 R 158 10-26-51

(Part of 39.63 Ac)

JAMES

Ord. 430-48 (5-10-48)

(134.518 Ac.)
Part of 170.75 Ac

(5.875)

GOSHEN LANE VAC. ORD. 1032-61

0-59-D

0-59-D

0
59
D

N
142

0
59
D

0
59
M

3579

59
C



SCALE 1" = 200'

TAXING DISTRICT
COLUMBUS
MIF-GAH.

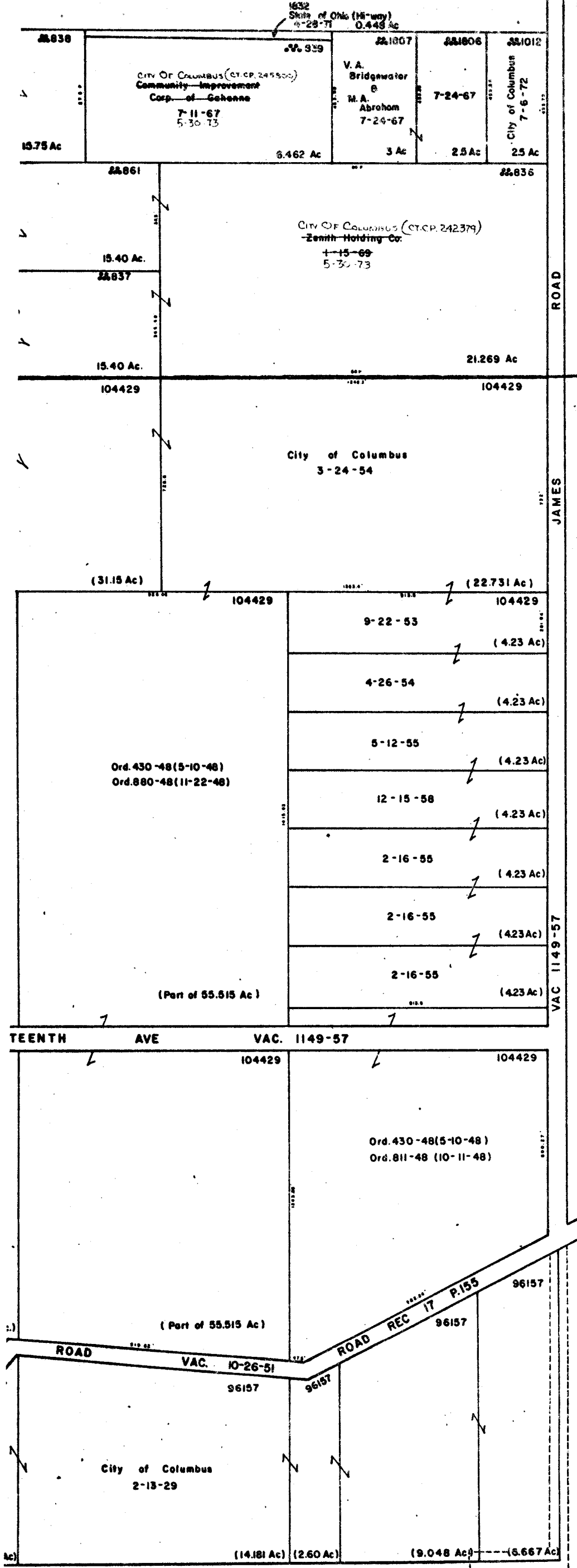

59
F

3580
0-59-E