

T W R

100

C L I N T O N

108773  
Academy Operating Co.  
11-17-57 0136Ac

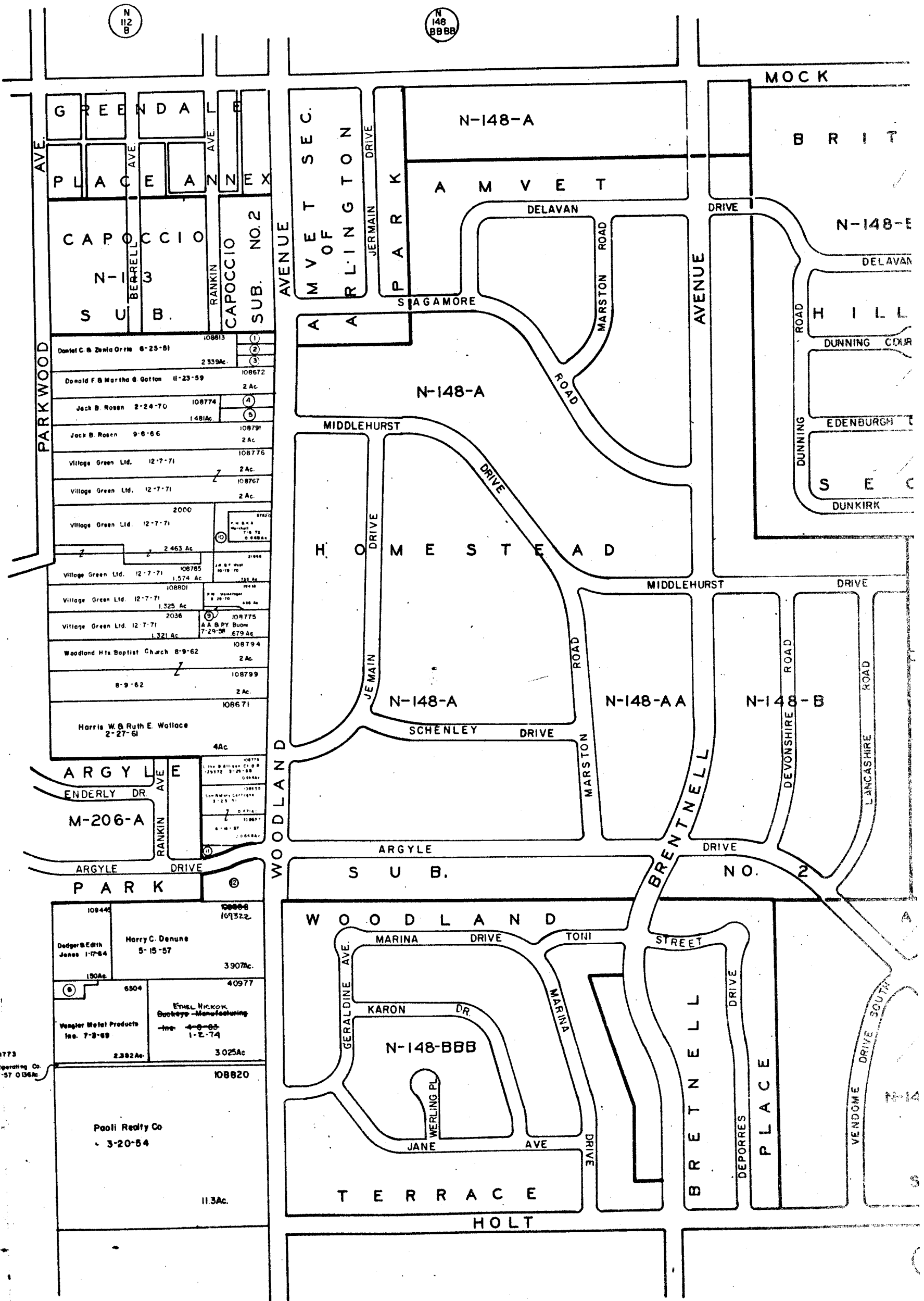

0-58-C  
 MIFFLIN TWP.  
 R.17 TWP.1

SCALE 1"=200  
 TAXING DISTRICTS  
 COLUMBUS  
 \*COLS. MIFFLIN  
 \*MIFFLIN

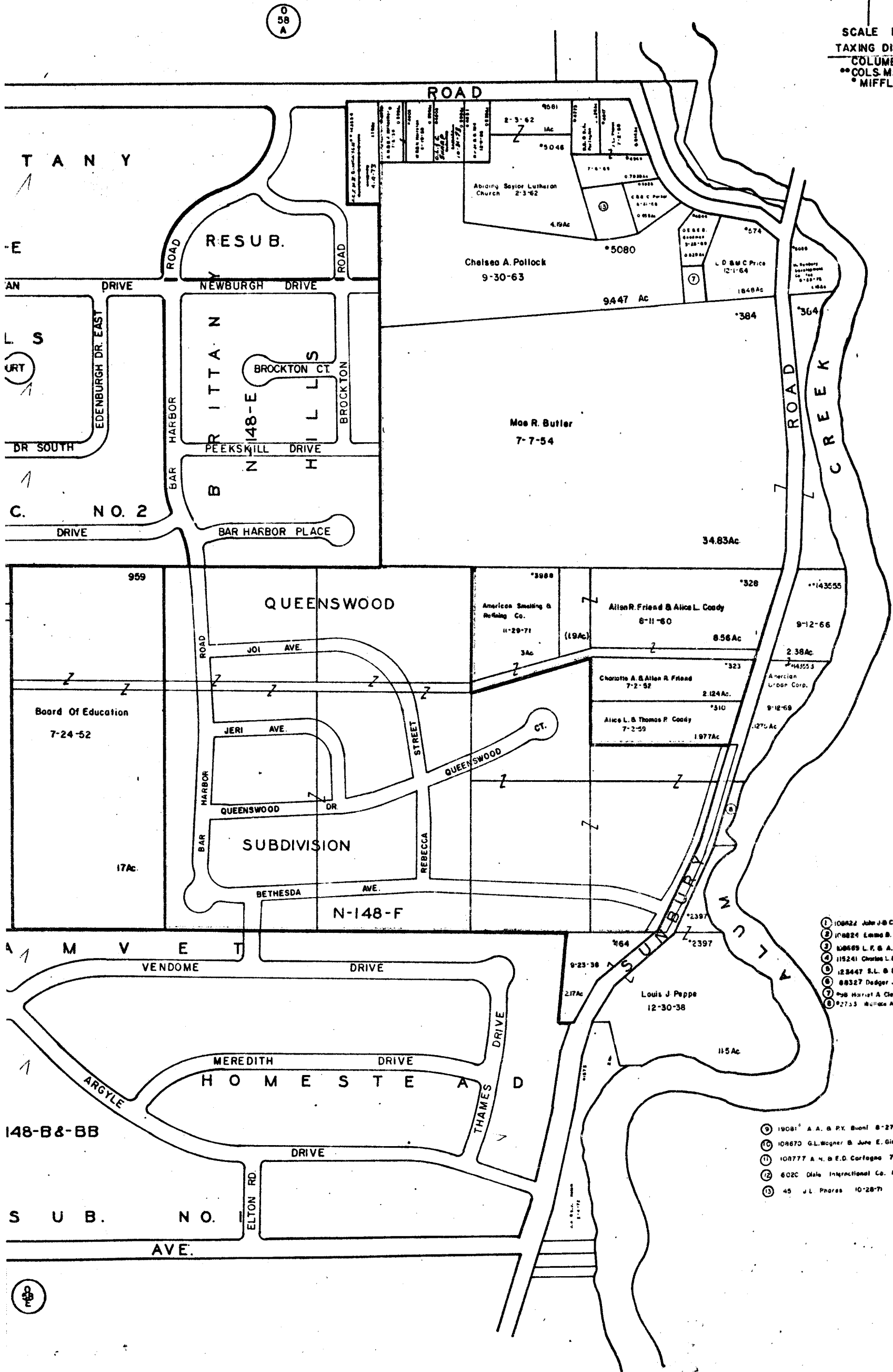

- ① 10842 John J. & Catherine A. Dow 1-20-56 0.8
- ② 10824 Emma B. Alton 6-18-65 0.150Ac.
- ③ 10669 L. F. & A. Nash 1-9-75 0.215 Ac
- ④ 115241 Charles L. & Annie B. Rhodes 9-11-67 0.
- ⑤ 12847 S.L. & D.L. Pruitt 9-28-72 .26
- ⑥ 88327 Dodger Jones 5-3-65 0.2Ac
- ⑦ Pub. Harriet A. Clemens 6-4-53 Dwp. 12.081A
- ⑧ 92733 Wallace A. Achely 7-6-53 0.83Ac

- ⑨ 19081 A. A. & P.V. Buoni 8-27-70 .039 Ac
- ⑩ 108670 G.L. Wagner & June E. Gilbert 3-28-62 0.46 Ac
- ⑪ 108777 A. H. & E.D. Corfoglio 7-17-68 .25 Ac
- ⑫ 602C Dale International Co. 10-20-71 .821 Ac
- ⑬ 45 J.L. Phares 10-28-71 .675 Ac