

0 42 D

The Williams Road Co.
2-2-73

1566C1

6.98Ac.

15655F

Dorothy M. Davis & Marguerite C. Hinton

1-25-62

114083

60.298Ac.

114084

33

Samuel E. Schultz & Fox Smith
9-12-72

Ricourt Realty Co.
1-7-66

28.828Ac.

34.072Ac.

876
State Of Ohio
4-28-71

877
James E. Gilman
9-7-71

WILLIAMS ROAD

ROAD

891

883

4-20-73

Ball, Ball, Galloway & Jacobs
5-4-73
13.3485Ac.
13.2085Ac.

DIRECTORS BOULEVARD

885

4-20-73

20.6085Ac.
25.0185Ac.
26.0185Ac.
30.3485Ac.

1171

1-29-74
4-20-73

12-00-73

4.10Ac.

1.50Ac.

PT OF 891

Madison Township
4-19-23

25.944Ac.
PT. OF 892
PT. OF 892

MADISON LOCAL SCHOOL DISTRICT
6-25-73

124.943Ac.

PT. OF 43.198Ac.

0 45

6

3405

0 41 D

0 40

ROAD

HENDRON

ROAD

HAMILTON

THE RIVERS

N-122-PP

N-122-PPP

38.20Ac.
20.24Ac.

BIG WALNUT

CREEK

0-42-G

MADISON TWP
R.21 TWP.11



SCALE 1" = 200'
TAXING DISTRICTS
MADISON
*** MADISON TWP - GROVEPORT CORT
*** CITY OF COLUMBUS - MADISON - S.D.

See 0-42-D



Part of William A. Allen & E. J. ...
COLUMBUS ROAD CO. ... (Part of Hi-Way ...)

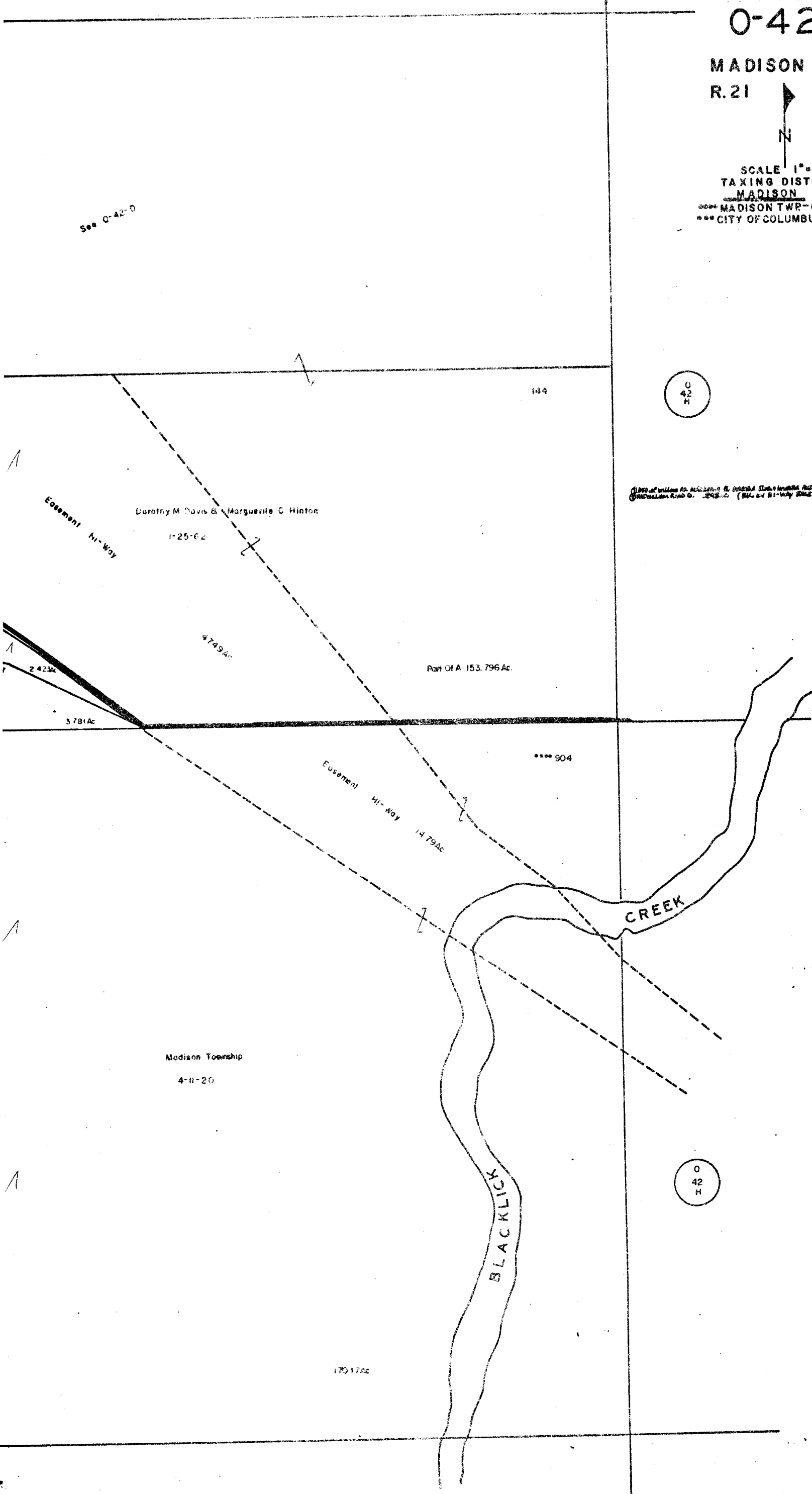

A

A

A

A

0-42-G

3406